

CHEMfix 612_{MP}

Bridge & Parking Deck Expansion Joints

Description

Expansion Joint CHEMfix 612, expansion joints are made to accommodate total movement up to 100 mm between the deck slabs of bridges. CHEMfix 612 can accommodate a difference in substrate level of approx 6 mm. Waterproof and does not require any additional water proof layer underneath, Suitable anchor bolts are used to fix them as concrete inserts. The deformable rubber segments are vulcanized bonded with high strength steel reinforcements. Expansion Joint CHEMfix 612 joints also allow displacement and rotation of the structural components to each other in any direction.

Corrosion Resistance:

The steel reinforcement is completely embedded into rubber therefore it is protected from corrosion.

Noise Free:

The special design of the rubber cover enables the joint to produce little noise while traffic passes over the joint.



Simplified Assembly:

Bridge Joint CHEMfix 612 is very easy to install; the one meter length of each element is made for easier installation compared to other shorter expansion joints. The joint's elements are connected together with male-female coupling and fixed to the structure with anchor bolts.

Waterproof Joints:

Expansion Joint CHEMfix 612 is entirely waterproof. An additional waterproof strip may be fixed under the mats that could collect water preventing any leakage.

Service Life:

The strong steel reinforcement and special abrasion resistant rubber used to manufacture joints has been designed to withstand the impact of heavy traffic, the action of oil, grease and gasoline, and the effects of ageing due to constant exposure to sunlight and weathering hence these joints are capable of providing trouble free long service life of many years.

Ease of Replacement:

The joint is a particularly suitable for replacing existing joints by removing the anchor bolt nuts only.

Size & Dimensions:

Model	Movement mm	Dimension WXHXL mm	Pitch mm	Weight
CHEMfix 612	± 50mm Total 100 mm	155 x 50 x 1000	313	11.5Kg/m eter

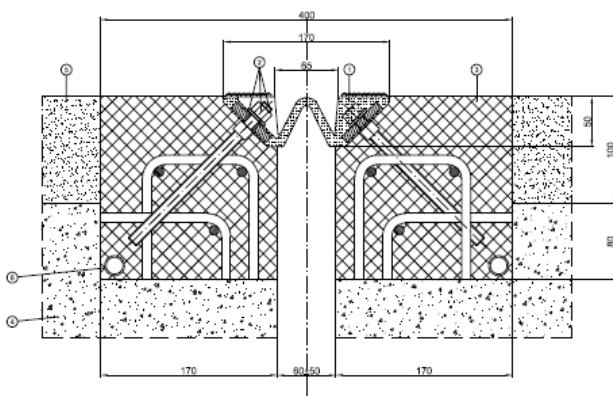
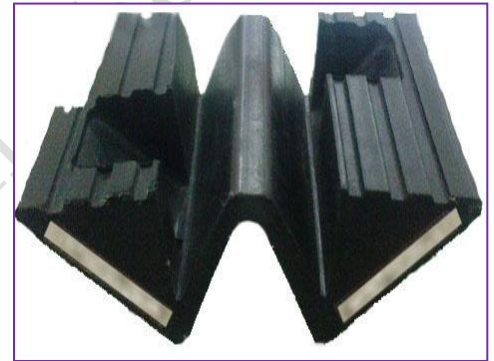

6	Drain Pipe
5	Asphalt
4	Concrete
3	Transition slab
2	Anchor bars + Washers + Nuts
1	Expansion Joint

Quality & Standard:

CHEMfix Expansion joints are designed and manufactured in accordance with the requirements of the International standard. Every single component is molded and assembled by fully qualified and trained workers at factory with regular external inspections according to PCSIR and under strict quality control.

Technical Data:

Characteristics	Test Method ISO	Test Method ASTM	Req. Value
Tensile Strength (Mpa)	37 type 2	D412	15, 5
Elongation at break (%)	37 type 2	D412	450
Compression Set 25h; 70 C	815	D395	max 25%
Hardness	48	D2240	60 ± 5
Resistance to Oil 70 hrs at 100 C	1817	D471	Max 10%
Resistance to ageing - variation in hardness - Variation in tensile strength at breaking - Variation in elongation at breaking	188	D573	max ± 15 max ± 15% max -40%

Anchor Bolts Specifications:

Model	Anchor Bolt MxB
CHEMfix 612	M14 x 200

Material Properties:

The elastomer used in the molding process can be polychloroprene (neoprene), natural rubber or SBR rubber depending on the specification requested. CHEMfix can manufacture expansion joints also with only metal profiles in many designs and shapes like zigzag and tongue n grove joints.

Steel Reinforcement:

The internal vulcanized rolled steel reinforcements are in accordance with ASTM A 572 Gr 50 standard.

Installation Procedure:

We recommend the following installation for our expansion joints:

- Cutting of paving, demolition and cleaning of the slab.
- Installation of drainage pipe and casting of leveling high strength grout.
- Lying of expansion joints.
- Drilling and installation of chemical anchors if required.
- Transition strips pouring and finishing.
- We highly recommend that the asphalt should be laid before starting the installation, then the asphalt concrete should be cut back and joint installed as per above procedure.



Guarantee:

CHEMFIX 612 are warranted against any defects due to the manufacturing process and raw materials. The warranty covers the products supplied by CHEMfix and expires if the products are incorrectly stored, handled, installed and maintained. For correct installation, please refer to CHEMfix Expansion Joints installation instructions.

The information and recommendations above are given in good faith based on our current knowledge and experience of the products when properly stored, handled and applied in accordance with current best practice, national standards and our recommendations. As we have no control over site conditions or methods of application, no liability can be derived from the contents of this information sheet, or from any written recommendations, or from any other advice offered. The user of the product is solely responsible for the product's suitability for the intended application and is recommended to test the suitability prior to use. We reserve the right to change the properties of our products without notice. All orders are sold subject to our current terms of sale and delivery. With the publication of this Technical Information Sheet all previous editions are no longer valid.

82, Great Eastern Street London EC2A 3JF. UK. Tel: 02-07-2477775 - 07-811155379 (Associated Company of I-Courier)
E-Mail: info@chemfix.org Web Site: www.chemfix.org ,
www.chemfixnigeria.com